



This product is intended for use with UL Listed products and must be installed by a qualified professional installer.

Maximum Load Capacity: 25 lb (11 kg)

Read instruction sheet before you start installation and assembly.

▲ WARNING

- Installer must verify that the ceiling will safely support four times the combined weight of all attached equipment and hardware.

NOTE: Accessories listed in the included sheet, as well as other parts, can be ordered through Peerless by calling 1-800-729-0307 or visiting www.peerlessindustries.com.

Turn to the appropriate page for your ceiling installation.

Installations:	
To Wood Joist Finished Ceilings, Exposed Wood Joists, or Wood Beam Ceilings	step 2, page 3
To Concrete Ceilings	step 3, page 4
Applications:	
Threaded Rod	step 4, page 5
Extension Column	step 5, page 5
Projector Alignment:	
Adjusting Roll, Pitch, and Yaw	step 12, page 8

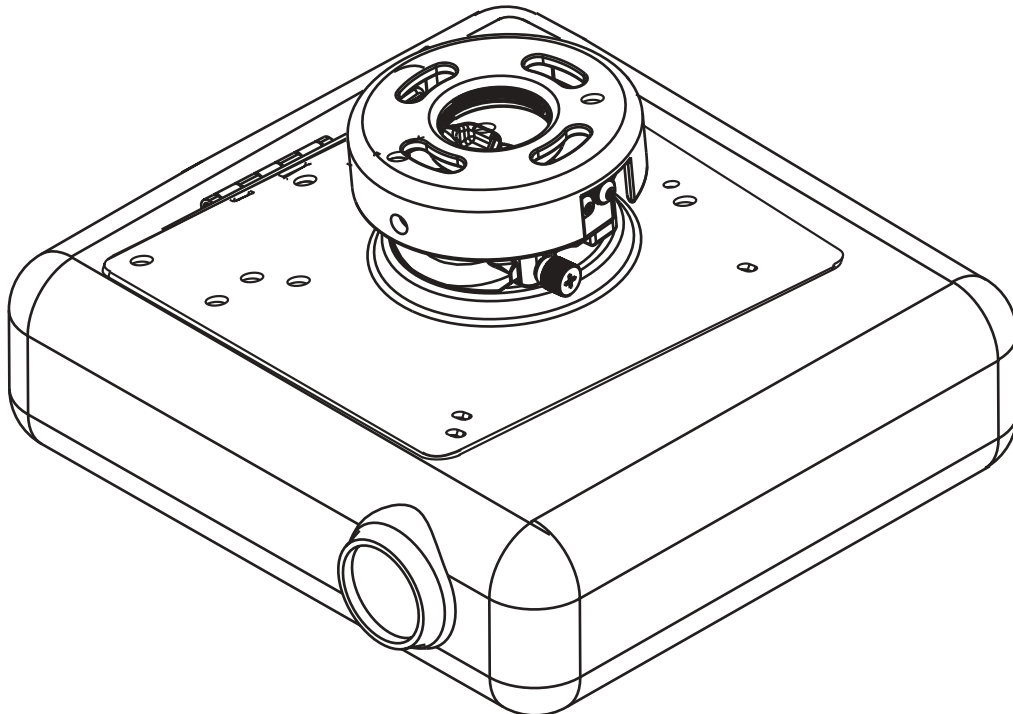

Before you start check the parts list to insure all of the parts shown are included.

Parts List

Description	Qty.	Part Number
A projector mount assembly	1	055-0422
B 4 mm security allen wrench	1	560-9646
C #10-32 x 3/8" serrated washer head socket pin screw	2	520-2151
D #10-32 x 1/4" socket pin screw	1	520-2196
E 1/4" flat washer	2	540-9440
F #14 x 2.5 phillips hex head wood screw	2	5S1-015-C04
G concrete anchor	2	590-0097
H adapter plate	1	055-2654
I M4 x 20 mm serrated washer head socket pin screw	2	510-2163
J .313 x .198 x .5H retaining spacer	2	590-2017
K .313 x .198 x .688H retaining spacer	1	590-2131
L M4 x 25 mm thumb screw	1	560-7142
M .313 x .198 x .25H retaining spacer	1	590-5004
N M4 x 10 mm thumb screw	1	560-7007
O cable clip	1	590-1167
P cable tie	1	560-9711

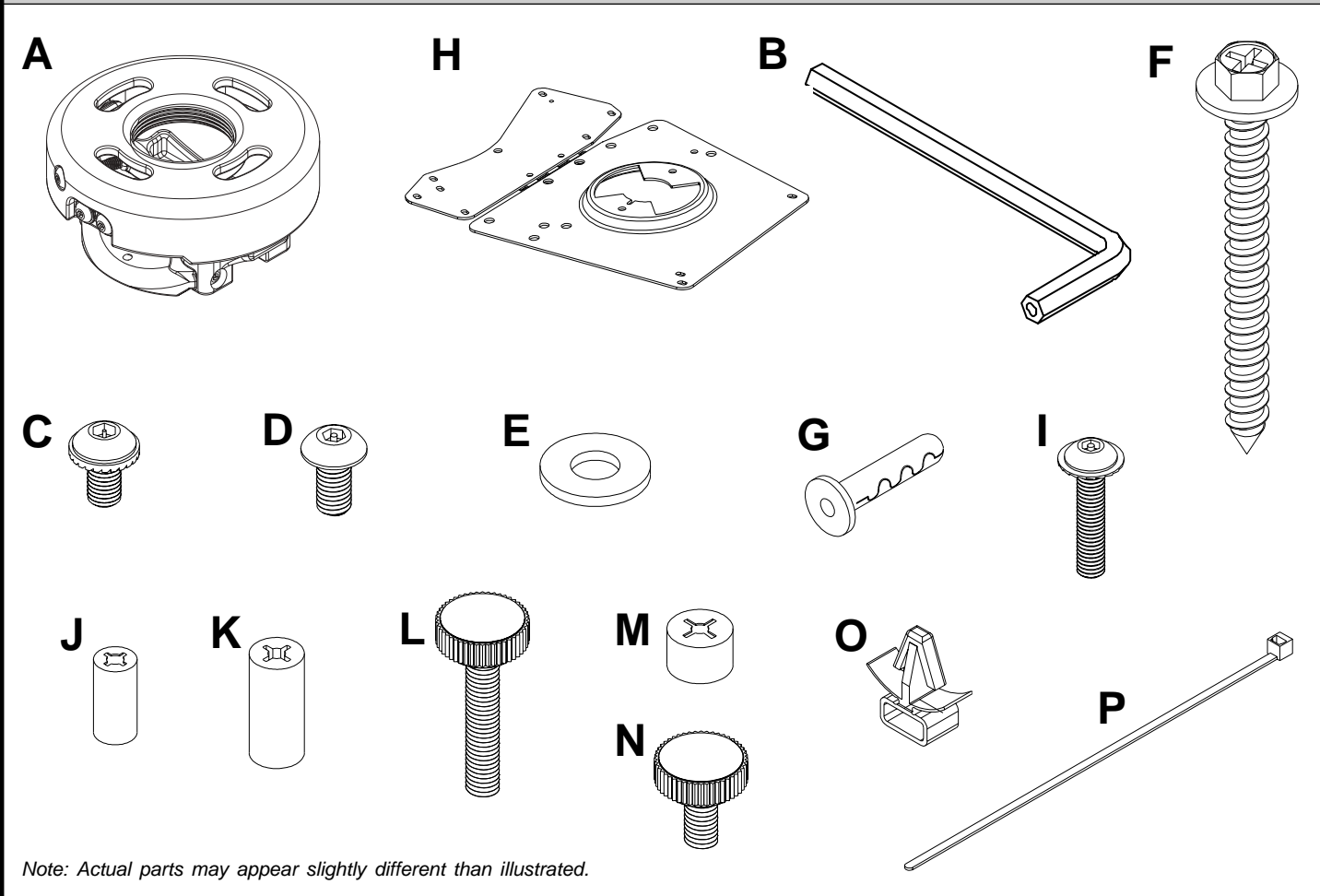

Note: Actual parts may appear slightly different than illustrated.

Accessories listed in the included sheet, as well as other parts, can be ordered through Peerless by calling 1-800-729-0307 or visiting www.peerlessindustries.com.

- 1 Disengage connection block from projector mount assembly (A) by unscrewing captive screw and sliding out connection block as shown.

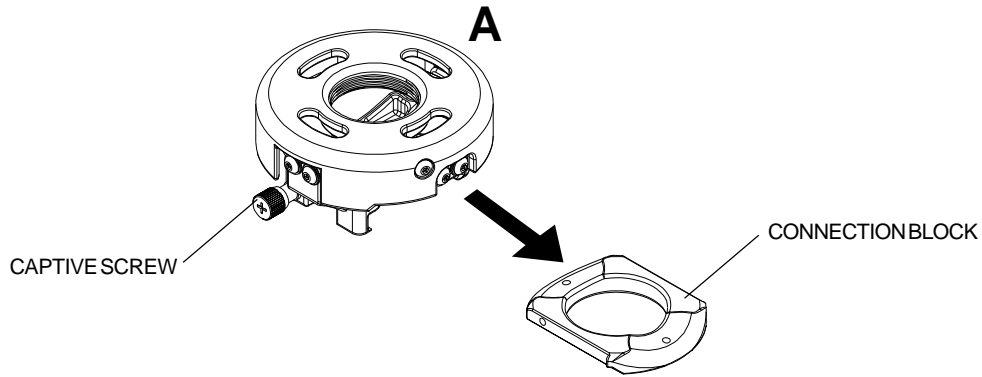

Installation To Wood Joist Finished Ceilings, Exposed Wood Joists, or Wood Beam Ceilings

- 2 Drill two 5/32" (4 mm) dia. holes to a minimum depth of 2.5" (64 mm). Attach projector mount assembly (A) with two #14 x 2.5" (6 mm x 65 mm) wood screws (F) and two flat washers (E) as shown in **figure 1** or **figure 2** depending on joist orientation. Tighten wood screws (F) using 3/8" (10 mm) socket wrench until projector mount assembly (A) is firmly attached.

Note: Be sure to drill holes into the joist CENTER!

Skip to step 6.

⚠ WARNING

- Installer must verify that the ceiling will safely support the combined load of equipment and all attached hardware and components.

CAUTION

- Do not tighten screws with excessive force. Overtightening can cause damage to mount. Tighten screws to 40 in. • lb (4.5 N.M.) maximum torque.

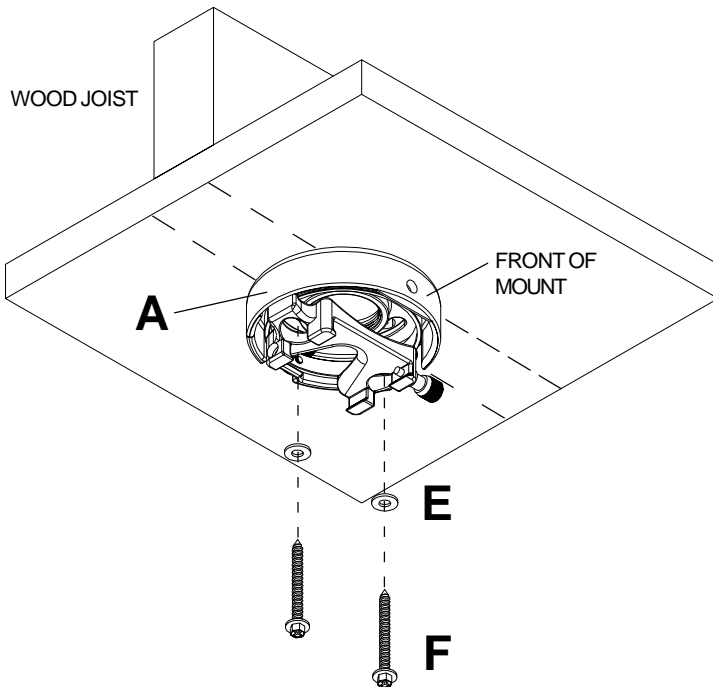

figure 1

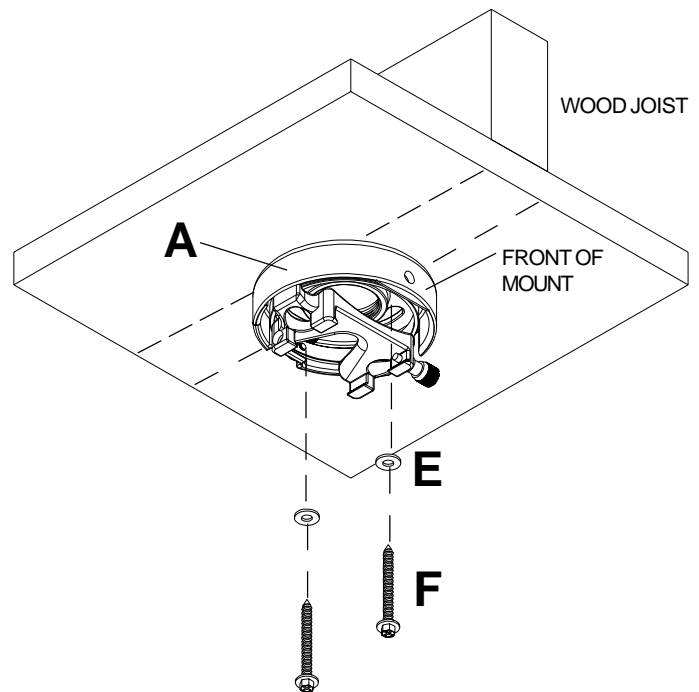

figure 2

Installation to Concrete Ceilings

3 Drill two 1/4" (6 mm) dia. holes to a minimum depth of 2.5" (64 mm). Attach projector mount assembly (A) using two concrete anchors (G), two flat washers (E), and two #14 x 2.5" wood screws (F) as shown in **Illustration A** and **1**, **2**, and **3** (below). Tighten wood screws (F) using 3/8" (10 mm) socket wrench until projector mount assembly (A) is firmly attached.

Skip to step 6.

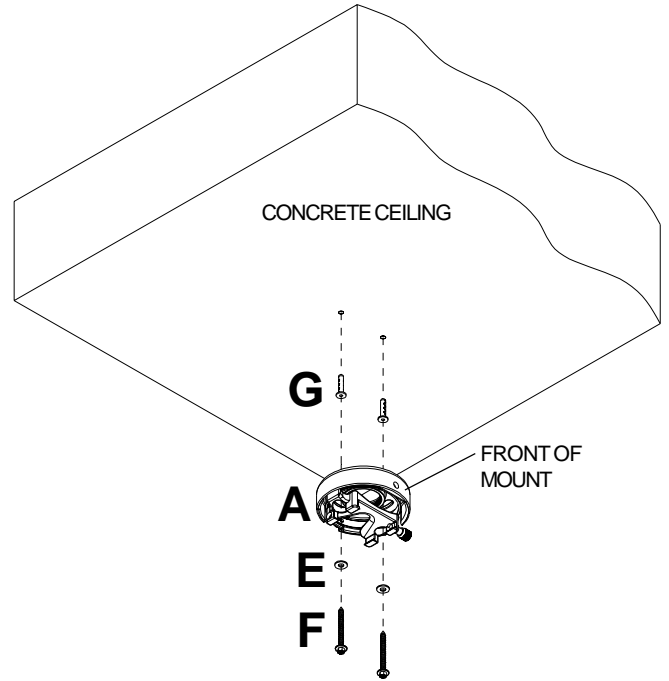

Illustration A

CAUTION

- Do not tighten screws with excessive force. Overtightening can cause damage to mount. Tighten screws to 40 in. • lb (4.5 N.M.) maximum torque.

WARNING

- Installer must verify that the ceiling will safely support the combined load of equipment and all attached hardware and components.

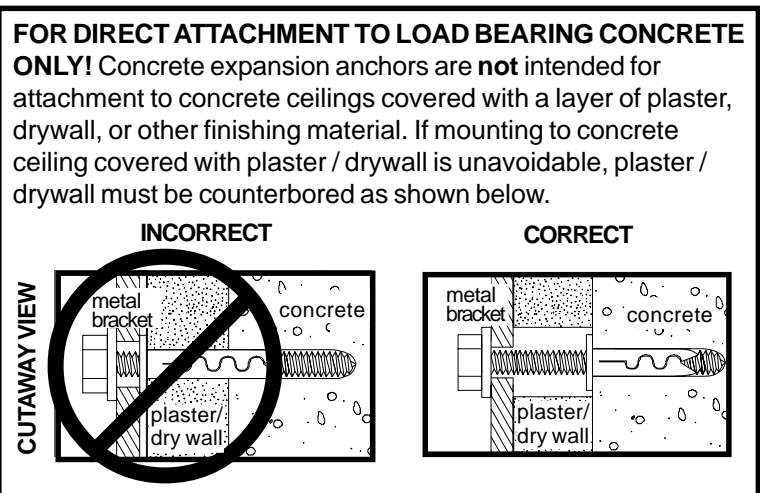
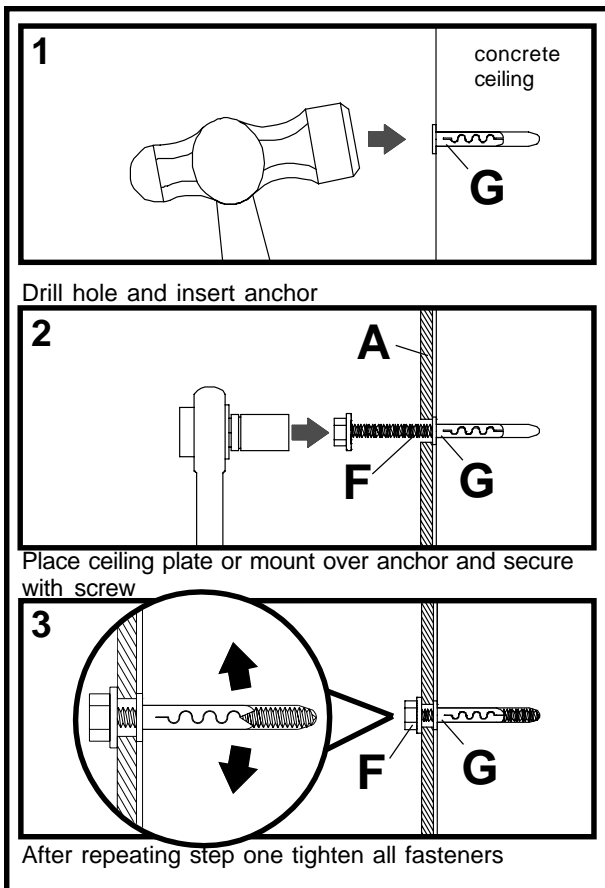

Installation to Threaded Rod

- 4** Attach projector mount assembly (A) to two 3/8-16 threaded rods (not included) using two 3/8-16 hex thin nylon-insert locknuts (not included) as shown in **figure 1.1** or **figure 1.2**.

Skip to step 6.

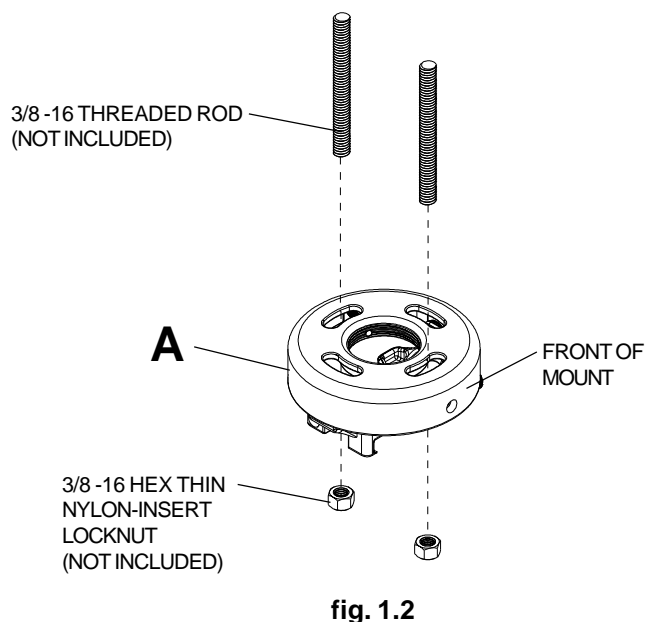
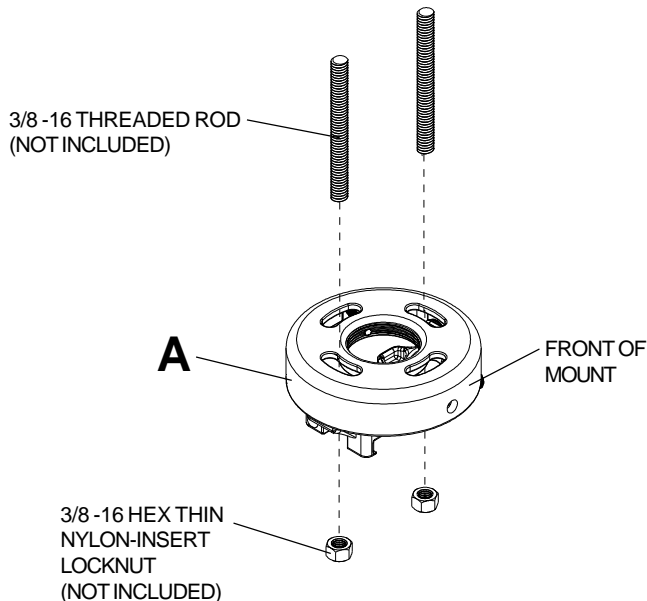

Installation to Extension Column

- 5** Screw projector mount assembly (A) onto extension column (sold separately) as shown in **figure 2.1**. **Note:** For 3/4" extension columns, reducer **ACC 913** will be required as shown in **figure 2.2**. Tighten swivel stop screw against extension column or reducer using security allen wrench (B). **Note:** Swivel stop screw is used to jam against threads of extension column or reducer to prevent any excess movement of projector mount assembly (A). Do not overtighten screw; overtightening screw will damage threads making it difficult to separate products.

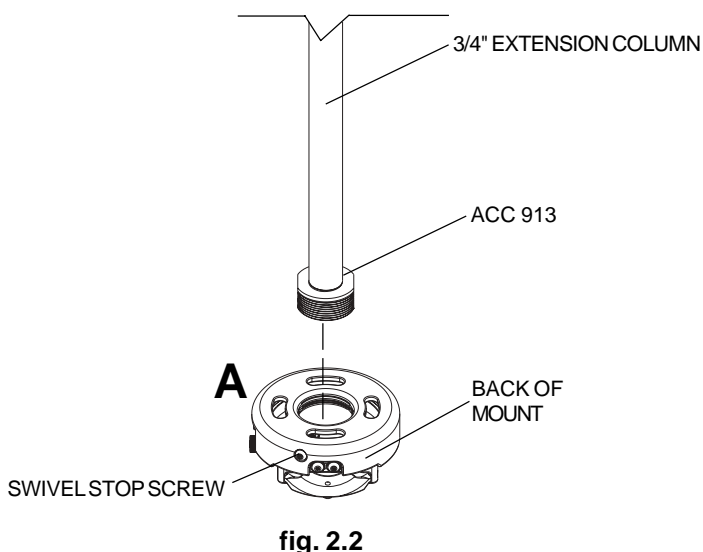
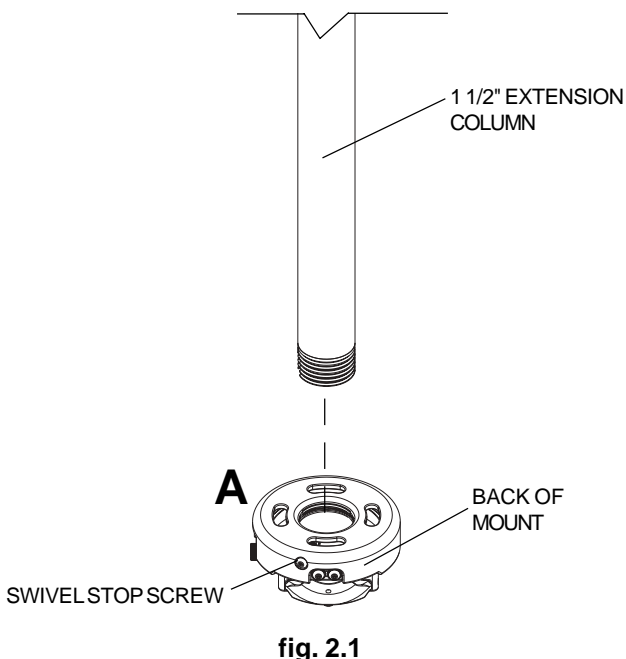

Note: The projector you are installing may differ in appearance from the sample illustrated below.

- 6** Align shoulder on connection block opposite notch in adapter plate. Attach adapter plate (**H**) to connection block from projector mount assembly (**A**) using two #10-32 x 3/8" serrated washer head socket pin screws (**C**) as shown.

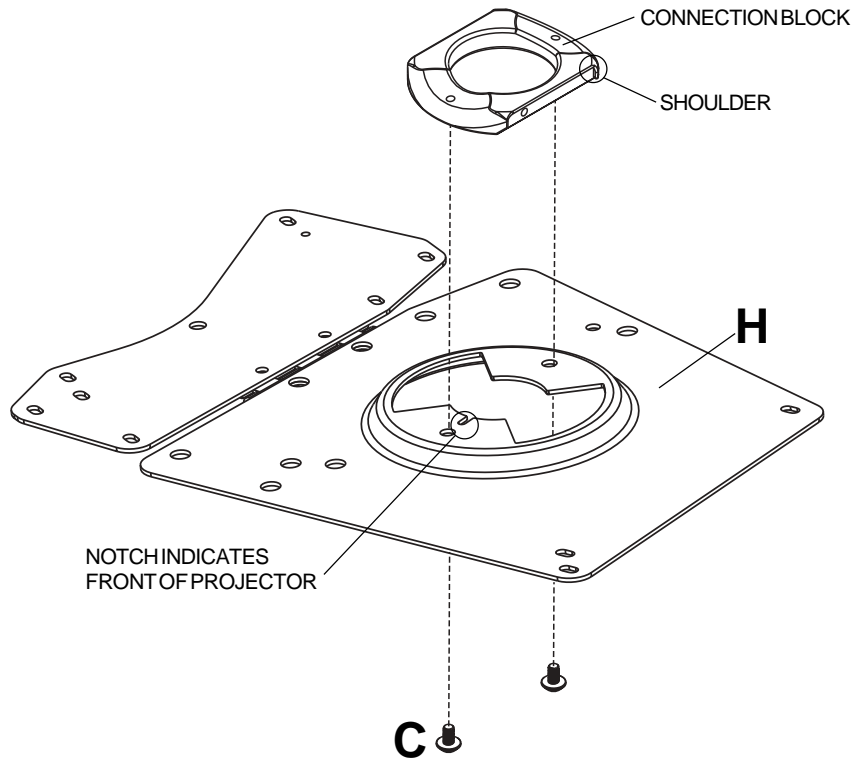

- 7** Flip projector upside down. Find your projector from the models listed below. Using the holes indicated on the corresponding hole pattern diagram, attach adapter plate (**H**) to projector using two M4 x 20 mm serrated washer head socket pin screws (**I**) and two .198 x .313 x .5 retaining spacers (**J**).

Notes:

Retaining spacers go between adapter plate and projector.

A. VT37, VT47, VT470, VT570, VT575, VT670, VT676, LT280, LT380

B. VT46, VT460, VT465, VT560, VT660, VT660k

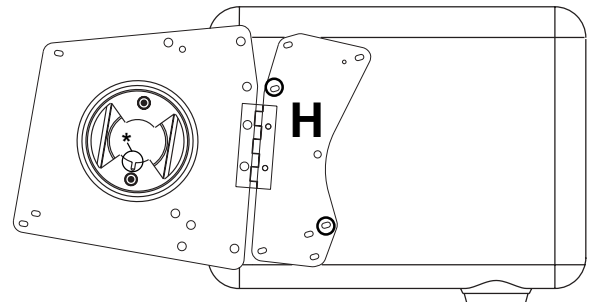
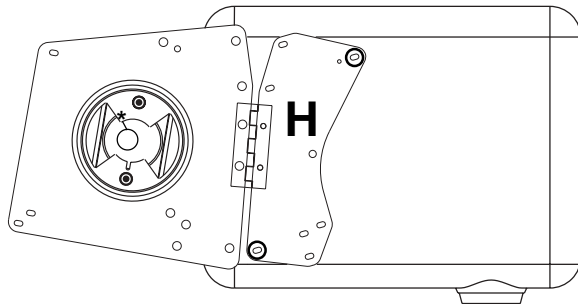

C. VT48, VT480, VT580

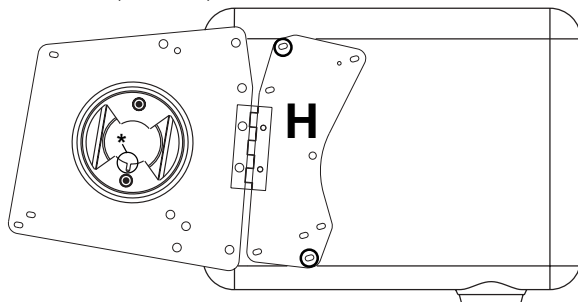

8 **OPTIONAL:** Press cable clip (**O**) into hole on adapter plate (**H**) indicated below. Pull on cable clip (**O**) to make sure it is engaged. Use cable tie (**P**) with cable clip (**O**) for cord management.

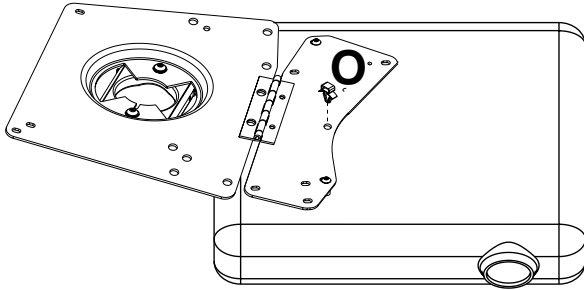

9 Fasten M4 x 10 mm thumb screw (**N**) and .313 x .198 x .25H retaining spacer (**M**) to adapter plate (**H**) as shown below.

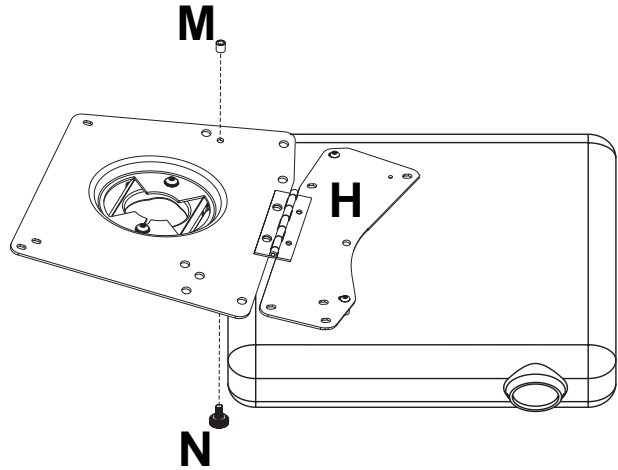

10 Find your projector from the models listed below. Fasten M4 x 25 mm thumb screw (**L**) and .313 x .198 x .688H retaining spacer (**K**) to adapter plate (**H**) at hole indicated on the corresponding hole pattern diagram. Close adapter plate (**H**) and tighten thumb screws (**L & N**).

A. VT37, VT47, VT470, VT570, VT575, VT670, VT676, LT280, LT380

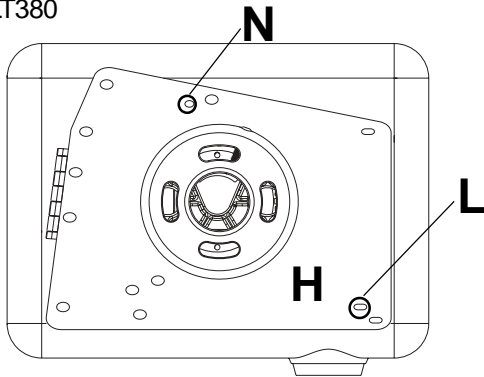

B. VT46, VT460, VT465, VT560, VT660, VT660k

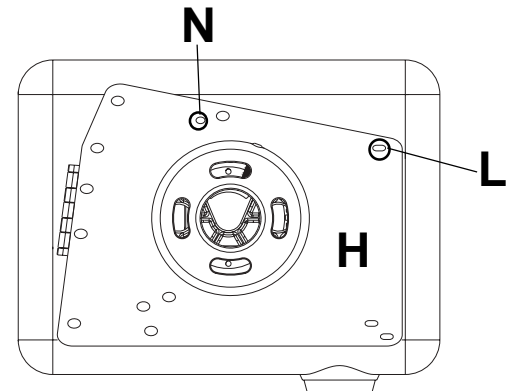

C. VT48, VT480, VT580

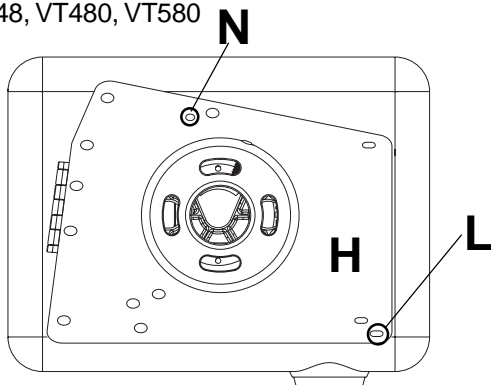

⚠ WARNING

- Do not lift more weight than you can handle. Use additional man power or mechanical lifting equipment to safely handle placement of the projector.

IMPORTANT: For security installations, insert one #10-32 x 1/4" socket pin screw (D) through projector mount assembly (A) and into connection block as shown.

- 11** Slide connection block with projector into projector mount assembly (A) as shown. Tighten captive screw to secure projector to projector mount assembly (A).

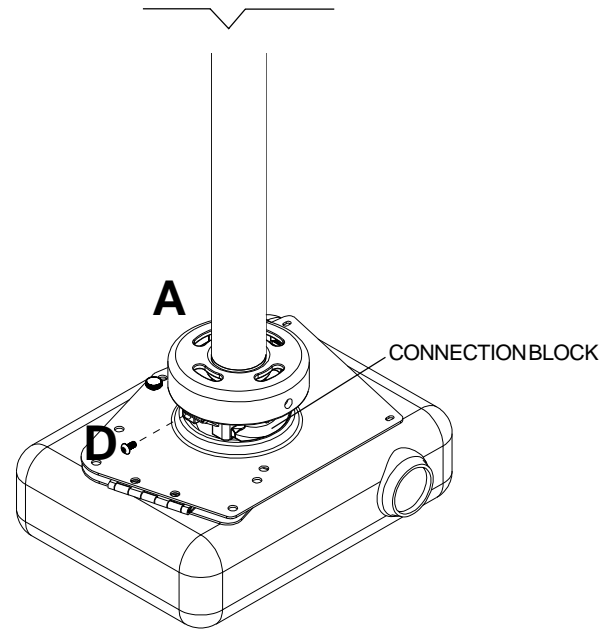
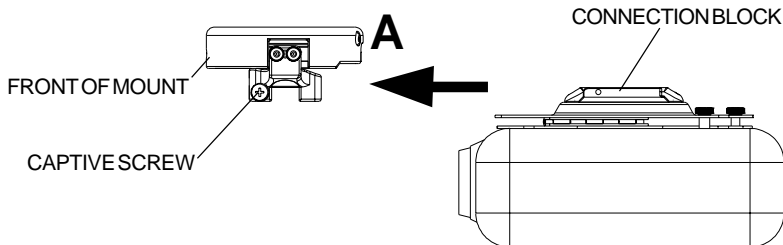

Projector Alignment

- 12** To adjust yaw (swivel) for wood stud, concrete ceiling, and threaded rod mounting applications: Loosen wood screws (F), or locknuts for threaded rods, until projector mount can be rotated. Rotate mount to desired position and retighten screws or locknuts.

To adjust yaw (swivel) for extension column applications: Loosen screw on projector mount assembly (A) indicated below until projector mount can be rotated. Rotate mount to desired position and retighten screw.

To adjust pitch (forward and backward tilt): Loosen two screws on projector mount assembly (A) indicated below. Tilt mount to desired position and retighten screws.

To adjust roll (side to side tilt): Loosen two screws on projector mount assembly (A) indicated below. Tilt mount to desired position and retighten screws.

