

PX-42SP1U/PX-42SP1U/S

Instruction Manual

Thank you for purchasing the PX-42SP1U PX-42SP1U/S attachable speakers.

Before using this product, please read this Instruction Manual thoroughly so that you can use this product at its full functionality.

After reading, retain this manual in an easily accessible location so that you can refer to this manual whenever you have a problem or trouble during use.

This product is exclusively for use with NEC 42-inch plasma monitors.

Checking the Package Contents

Check that the following items are included in the delivered package. If any of the following items is missing or defective, immediately contact your dealer.

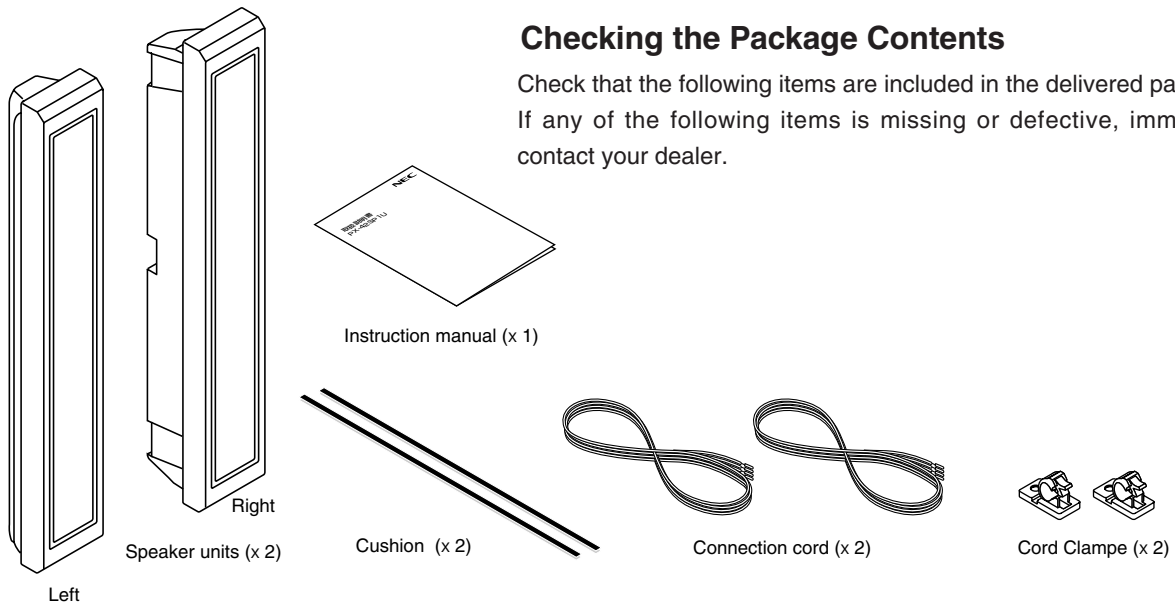

Mount fittings A

Mount fittings

R (right) (2 fittings)

L (left) (2 fittings)

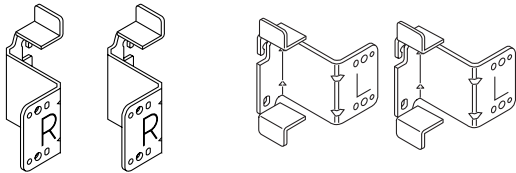

Mount fitting screws
M4 x 10 (8)



Monitor mounting screws
M4 x 14 (4)



Mount fittings B

Mount fittings

42R UP (right) (1 fitting)

42L UP (left) (1 fitting)

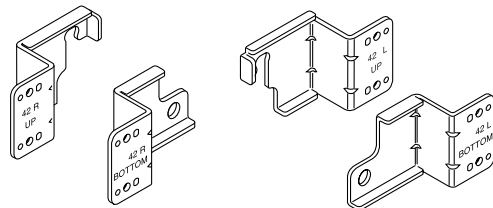

42R BOTTOM (right) (1 fitting)

42L BOTTOM (left) (1 fitting)

Mount fitting screws
M4 x 10 (8)



Monitor mounting screws
M8 x 18 (4)



Before Use...



Symbols



Various symbols are used in this Operating Instructions for the safe and proper use of the product as well as preventing any injury or damage to persons or property. These symbols and their meanings are described below. Please have a good understanding of these matters before reading the main text of the manual.

WARNING  Ignoring this indication and improper handling could be the cause of personal injury such as a serious injury or death.

CAUTION  Ignoring this indication and improper handling could cause injury to a person or damage to the surrounding household belongings.

Examples of Symbols

  This symbol informs that there are contents that **demand caution (including warnings)**.
Concrete details of the caution are written within the diagram.

  This symbol indicates a **prohibited** matter.
Concrete details of the prohibition are written within the diagram.

WARNING

 ● When the speakers are installed on the monitor, do not move the unit by lifting up the speakers.
The monitor could fall and cause injury.

 ● To ensure safety, tighten bolts and screws securely.
Failure to do so could cause the Plasma Monitor to tip over, resulting in injury.

CAUTION

 ● Do not set on shaky stands, tilted surfaces or other unstable places.
Doing so could cause the Plasma Monitor to tip over or fall, resulting in injury.
Moreover, Do not install a Plasma Monitor into a vehicle.

 ● Do not install the Plasma Monitor in humid or dusty places or places exposed to soot or vapor (such as in kitchens, near humidifiers, etc.). Doing so could lead to fire.

 ● Do not let any water get into or onto the speaker. Doing so could result in fire or electric shock.
Also, do not use the speakers outdoors. Doing so could result in fire or electric shock.

 ● Do not place heavy objects on the connection cords or let the cords run under the monitor. The cords could be damaged, leading to fire or electric shock.

 ● Do not insert or drop metal objects, easily inflammable objects, etc., into the openings in the speaker. Doing so could result in fire or electric shock. Homes or places with small children present should take particular care.

Note

This speaker is of an antimagnetic design; however, depending on its placement, for example, bringing the speaker into the vicinity of a monitor other than a plasma monitor, the speaker may cause irregular color or other effects. Should this occur, please move the speaker away from the monitor.

Care and Maintenance

When the cabinet gets dirty...

- Wipe with a lit-free, soft, dry cloth.
If the cabinet is seriously stained, soak a cloth in a neutral detergent solution, wring well and, after wiping, remove moisture by wiping with a dry cloth.
If you want to use a chemical cloth for cleaning, read well the caution provided with the chemical cloth product.
- Do not use solvent such as thinner or benzene for cleaning. Otherwise the surface finish will be deteriorated or the coating will be stripped off.
- To remove dust from the speaker nets, use a brush adapter of a cleaner. Avoid applying the cleaner inlet directly without using a brush adapter or using a nozzle adapter.
- To prevent damage to the cabinet and speaker nets, do not scratch or hit them with a fingernail or other hard object. Also do not stab the speaker nets with a sharp object to prevent marking a hole.

Do not apply volatile agent such as insecticide on the cabinet or leave a rubber or vinyl product in prolonged contact with it. Otherwise the surface finish will be deteriorated or the coating may be stripped off.

Selecting the mount fittings

Two types of mount fittings are provided, type A and type B.

The types of fittings are indicated on the boxes inside the cardboard box, as shown on the diagram. Use the mount fittings appropriate for your plasma monitor.

Do not use the other mount fittings.

Mount fittings A (L and R)

Applicable models

PX-42VP4** PX-42VP5**
PX-42VM5** PX-42VR5**
PX-42XM2** PX-42XM3**
PX-42XR3**

"**" indicates any characters.

If you will use mount fittings A, please proceed to "Mounting the plasma monitor using mount fittings A" on page 4.

Mount fittings B (42L and 42R)

Applicable models

PX-42XM4** PX-42XR4**

"**" indicates any characters.

If you will use mount fittings B, please proceed to "Mounting the plasma monitor using mount fittings B" on page 6.

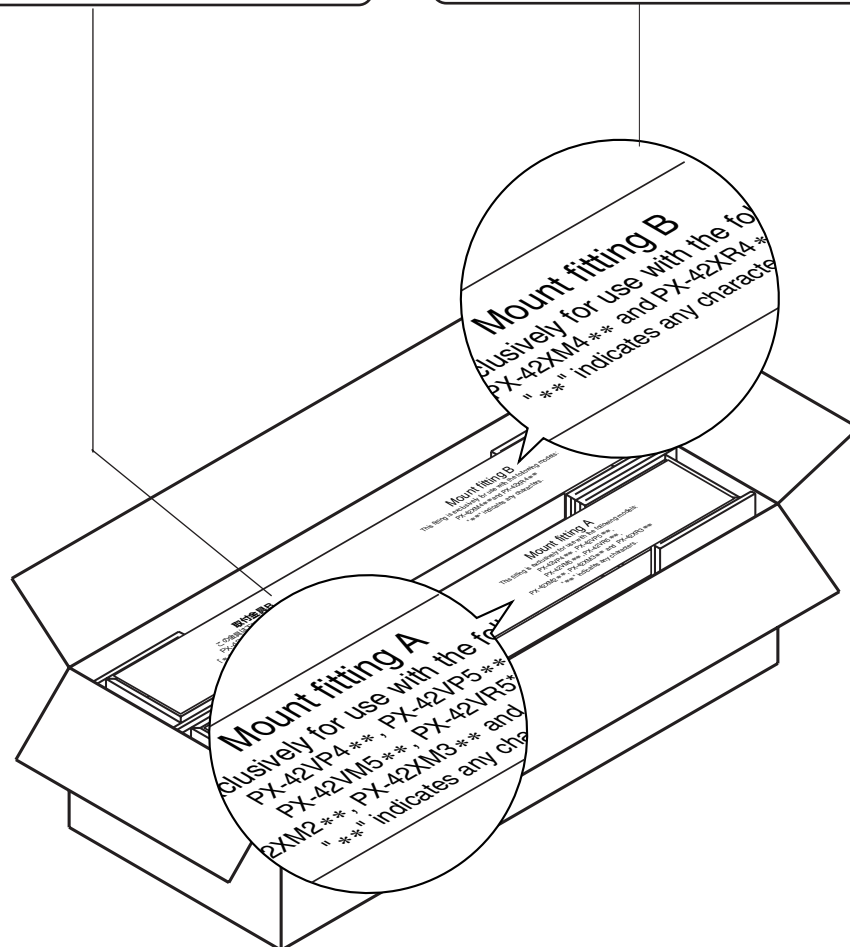

WARNING

- Be sure to use the mount fittings applicable to your plasma monitor. If the other fittings are used, the speakers could fall, causing injury.

Mounting the plasma monitor using mount fittings A

The speakers are marked R for use on the right side and L for use on the left side.

At the time of mounting, check for the letter R or L appearing on the label at the back of the speaker, and on the mounting fittings.

- 1 Attach the cushions to the sides of the speakers in the positions indicated on the diagram.

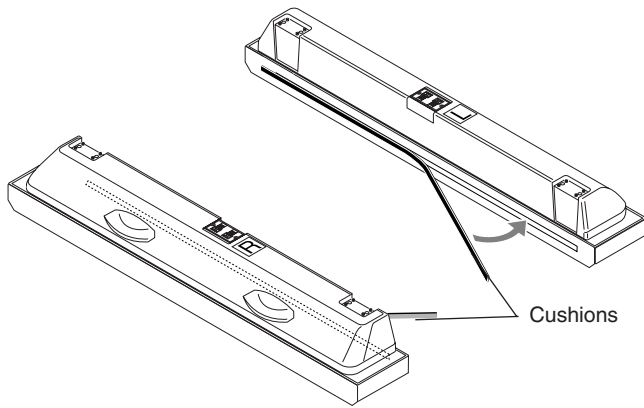

- 2 Mount the two right mount fittings ("R") to the speaker labeled "R", the two left mount fittings ("L") to the speaker labeled "L".

Mount by inserting the guide pins on the speaker into the holes in the mount fitting then fastening the fitting in place using the included M4 x 10 screws (two each).

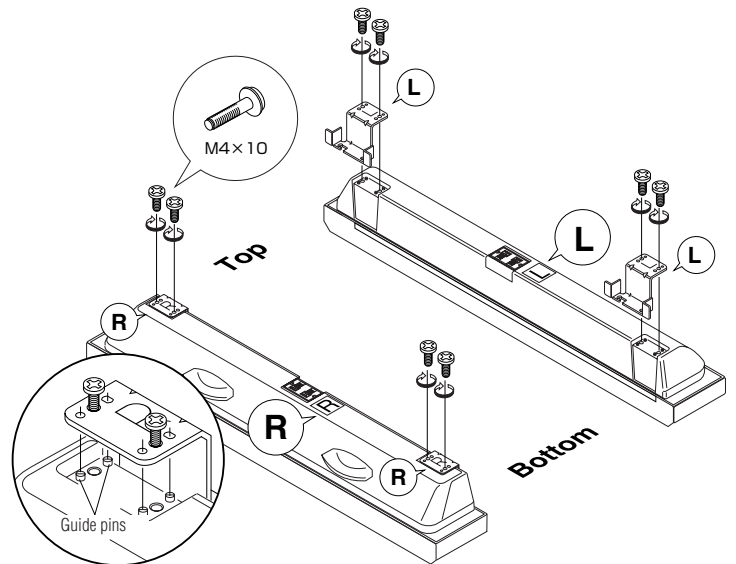

- 3 Partially tighten the included M4 X 14 screws in the screw holes on the top of the monitor.

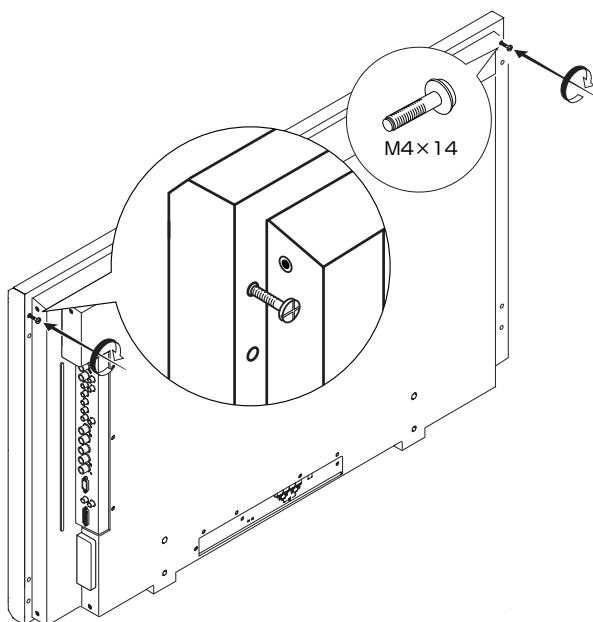

- 4 Catch the hooks at the top of the speaker on the partially tightened screws, then line up the screw hole in the bottom of the monitor with the hole in the speaker's hook and partially tighten using the included M4 x 14 screws (two each).

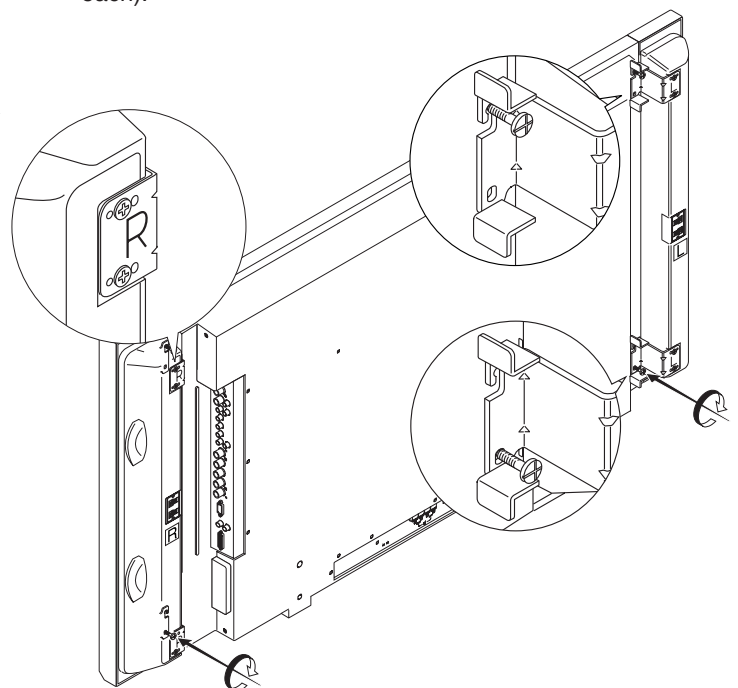

- 5** Fully tighten the four partially tightened screws.
 *Push the speaker against the monitor while driving the screw.

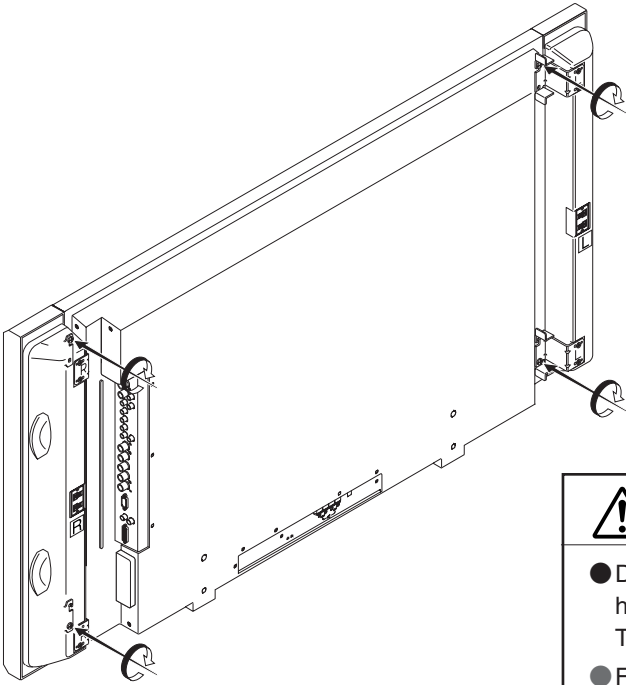

⚠ WARNING

- Do not move the monitor by holding onto the speakers which have been mounted to the monitor. This could cause the monitor to fall and result in injury.
- Fasten the screws securely. Failing to do so could cause the speakers to fall and result in injury.

Connecting the cords

Turn off the power of all connected units before connecting the cords.

Connect the display's SPEAKER R and L terminals with the speakers' terminals using the included connection cords.

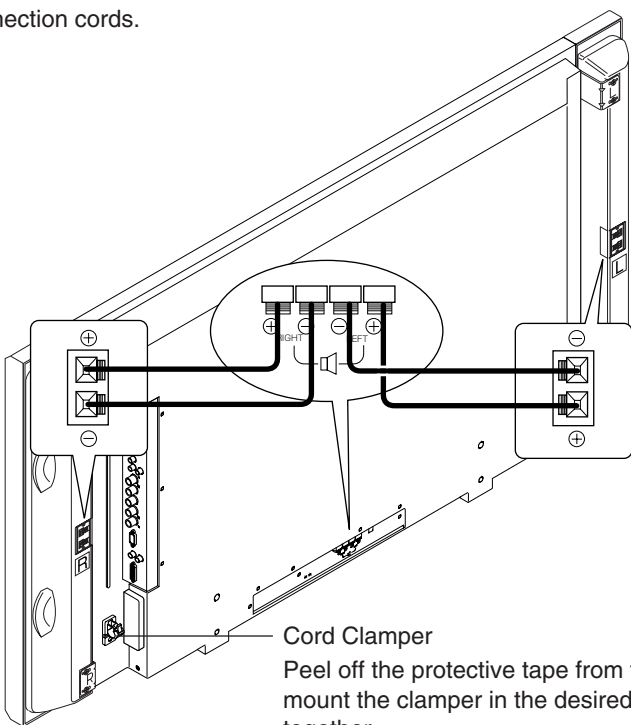

Cord Clamper
 Peel off the protective tape from the back of the clamper, then mount the clamper in the desired position and clamp the cords together.

There is polarity \oplus \ominus with the conductor of each connection cord.
 Connect each conductor to the correct terminal.

Hold down the button of the connection terminal with your finger, insert the conductor of the connection cable, and release your finger.

Mounting the plasma monitor using mount fittings B

The speakers are marked R for use on the right side and L for use on the left side.

At the time of mounting, check for the letter R or L appearing on the label at the back of the speaker, and on the mounting fittings.

- 1 Attach the cushions to the sides of the speakers in the positions indicated on the diagram.

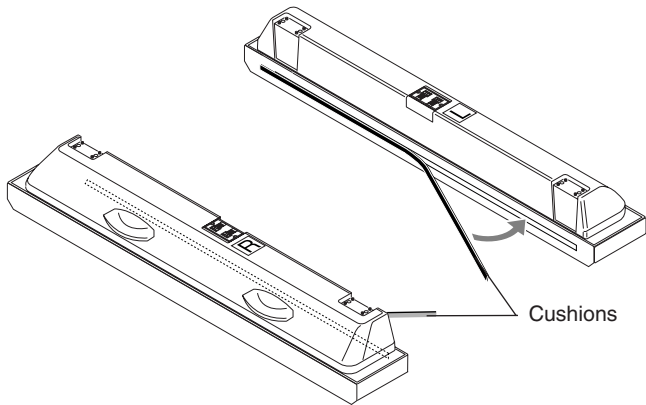

- 2 Check the speakers' labels ("L" and "R"), and place them as shown on the diagram below.

Mount the 42R UP mount fitting to the top of speaker R, the 42R BOTTOM mount fitting to the bottom of speaker R, the 42L UP mount fitting to the top of speaker L, the 42L BOTTOM mount fitting to the bottom of speaker L.

Mount by inserting the guide pins on the speakers into the holes in the mount fittings then fastening using the included M4 x 10 screws (two each).

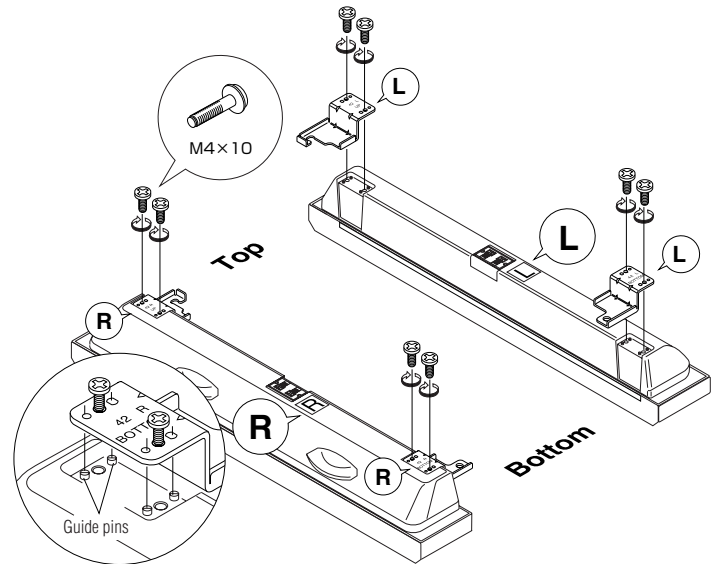

- 3 Partially tighten the included M8 X 18 screws in the screw holes on the top of the monitor.

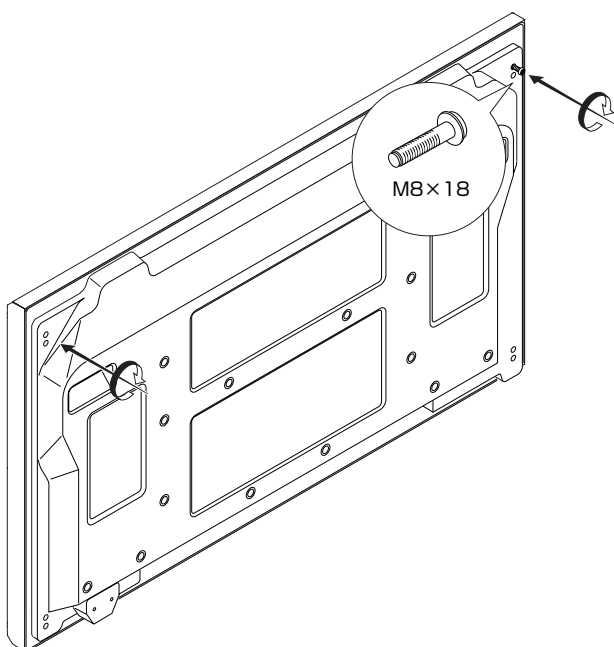

- 4 Catch the hooks at the top of the speaker on the partially tightened screws, then line up the screw hole in the bottom of the monitor with the hole in the speaker's hook and partially tighten using the included M4 x 18 screws (two each).

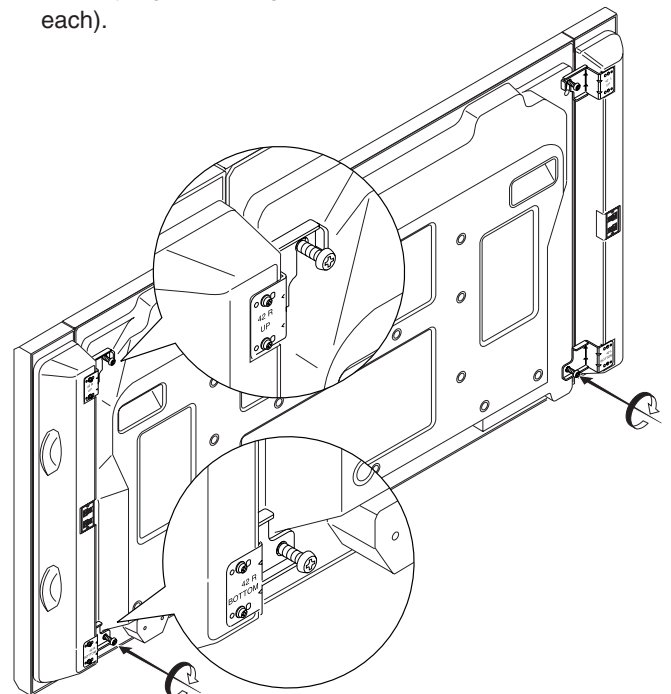

5 Fully tighten the four partially tightened screws.

*Push the speaker against the monitor while driving the screw.

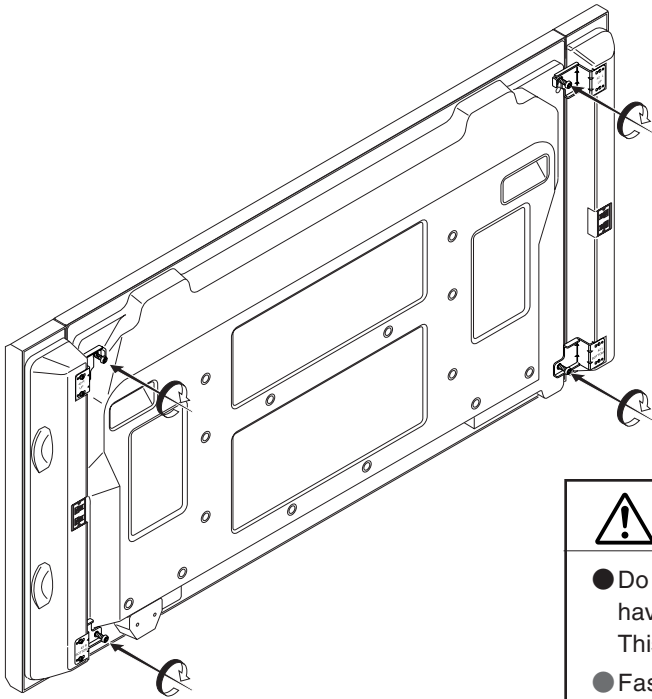

⚠ WARNING

- Do not move the monitor by holding onto the speakers which have been mounted to the monitor. This could cause the monitor to fall and result in injury.
- Fasten the screws securely. Failing to do so could cause the speakers to fall and result in injury.

Connecting the cords

Turn off the power of all connected units before connecting the cords.

Connect the monitor's SPEAKER R and L terminals with the speakers' terminals using the included connection cords.

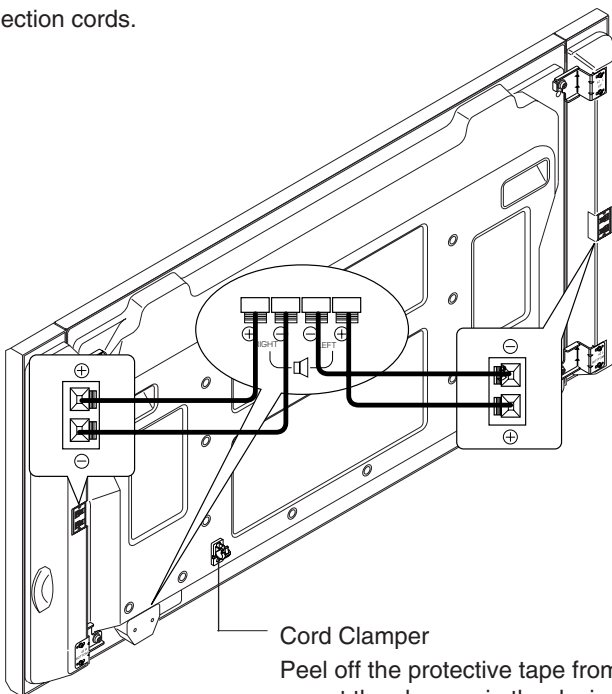

Cord Clamper

Peel off the protective tape from the back of the clamper, then mount the clamper in the desired position and clamp the cords together.

There is polarity \oplus \ominus with the conductor of each connection cord.
Connect each conductor to the correct terminal.

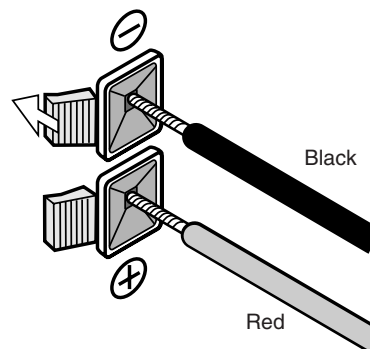

Hold down the button of the connection terminal with your finger, insert the conductor of the connection cable, and release your finger.

Specifications

Type : 2-way, 2-speaker system (bass reflex type) x 1
Impedance : 6Ω
Rated input : 10W
Max. input : 30W
External dimensions : 90(W) x 610(H) x 89(D)mm
 : 3.5(W) x 24(H) x 3.5(D)inches
Weight : Weight: 3.8 kg (2 speakers)
 : 8.4lbs (2 speakers)

●The design and specifications are subject to change without notice.

NEC and the NEC logo are registered trademarks of NEC Corporation.