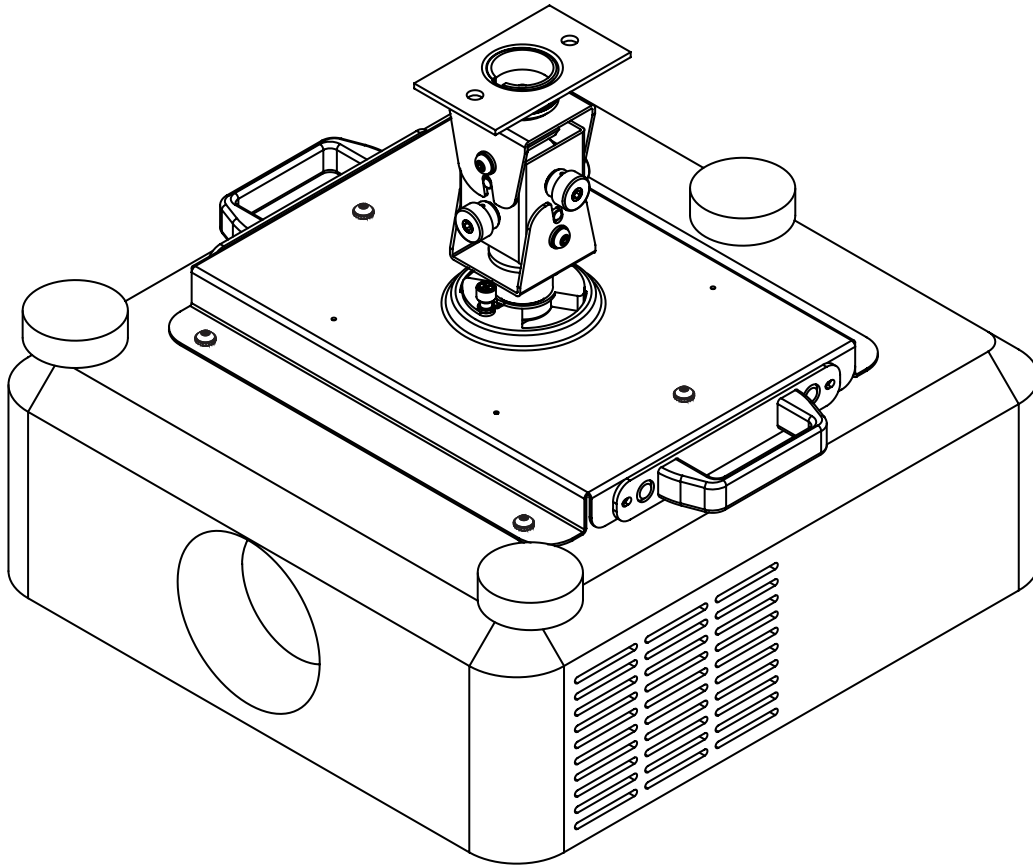

**NEC**

NEC DISPLAY SOLUTIONS OF AMERICA, INC.

**Installation and Assembly:  
Adapter Plate for NEC Projector  
Model PX-750U****Model: PX750CM****IMPORTANT! Read entire instruction sheet before you start installation and assembly.****Max Load Capacity:**  
60 lb (22.3 kg)**⚠ WARNING**

- Installer must verify that the ceiling will safely support four times the combined weight of all attached equipment and hardware.

**CAUTION**

- It is the responsibility of the installer to ensure that the projector is properly ventilated. Spacers are provided to raise the mount off the projector surface.

**NOTE:** Read entire instruction sheet before you start installation and assembly.

## Parts List

Description	Qty.	Part #
<b>A</b> adapter assembly	1	056-1061
<b>B</b> M4 x 12 mm socket pin serrated washer head screw	4	510-1079
<b>C</b> M5 x 10 mm socket pin serrated washer head screw	4	510-1126
<b>D</b> M4 x 40 mm socket pin serrated washer head screw	2	510-1091
<b>E</b> 4 mm allen wrench	1	560-9646
<b>F</b> .375 spacer	2	590-1140
<b>G</b> .75 spacer	2	590-1300
<b>H</b> projector mount assembly	1	055-1950
<b>I</b> column connector	1	580-1025
<b>J</b> ceiling plate	1	580-1042
<b>K</b> .25" x .5" x .25" spacer	2	590-1050
<b>L</b> #10-32 x 3/8" thumb screw	1	560-1107
<b>M</b> #10-32 x 3/8" socket pin serrated washer head screw	1	520-1151
<b>N</b> 10-32 x 3/8" slotted set screw	3	520-1187
<b>O</b> concrete anchor	2	590-0320
<b>P</b> #10-32 x 3/8" socket pin screw	2	520-1084
<b>Q</b> #14 x 2.5" wood screw	2	5S1-015-C03
<b>R</b> 5 mm allen wrench	1	560-0216
<b>S</b> M5 x 10 mm type-F screw	1	520-1164

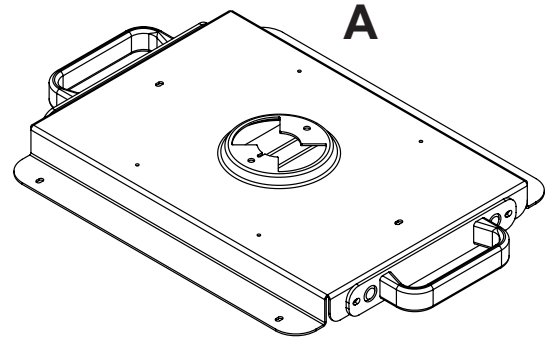

**B**



**C**



**D**

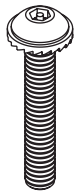

**E**

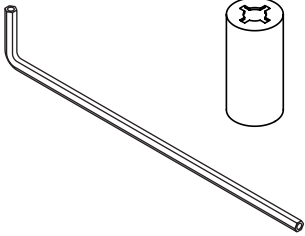

**F**

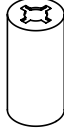

**G**



**H**

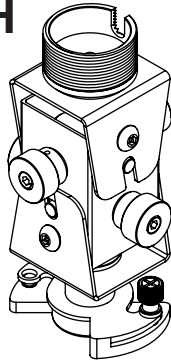

**I**

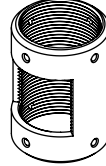

**J**

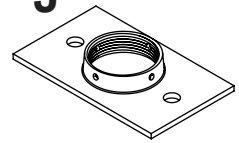

**K**

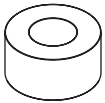

**L**



**M**

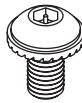

**N**



**O**

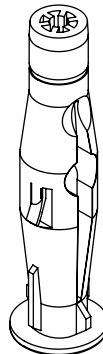

**P**



**Q**

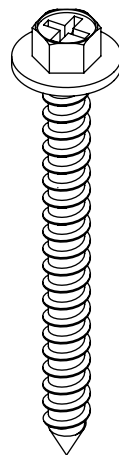

**R**

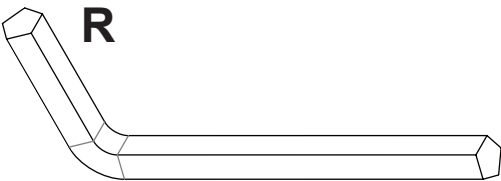

**S**



Before you start make sure all parts listed are included with your product.

# Installation To Wood Joist Finished Ceilings, Exposed Wood Joists, or Wood Beam Ceilings

**1** Drill two 5/32" (4 mm) dia. holes to a minimum depth of 2.5" (64 mm). Attach ceiling plate (J) to ceiling with two #14 x 2.5" wood screws (Q) using 3/8" (10 mm) socket wrench as shown in figure 1.1.

**NOTE:** For optional cord management, install two spacers (K) between ceiling plate (J) and ceiling as shown in figure 1.2.

*Skip to step 2 for flush mount installation.*

*Skip to step 3 for extension column installation.*

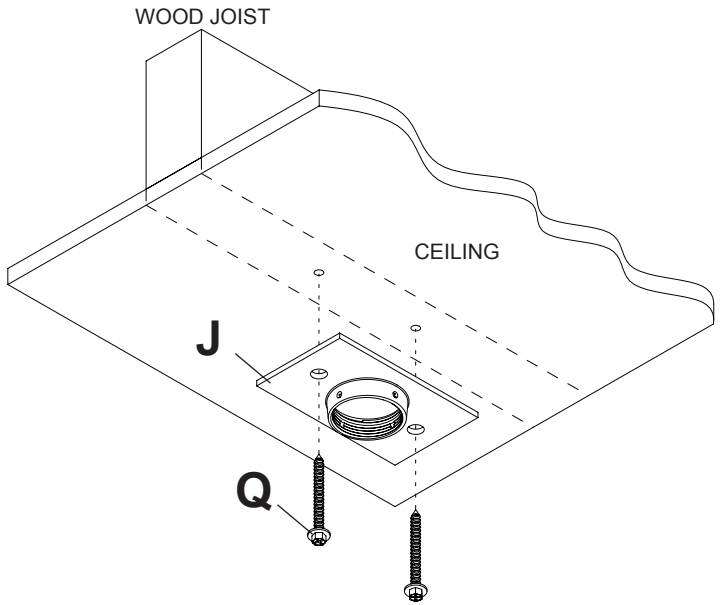
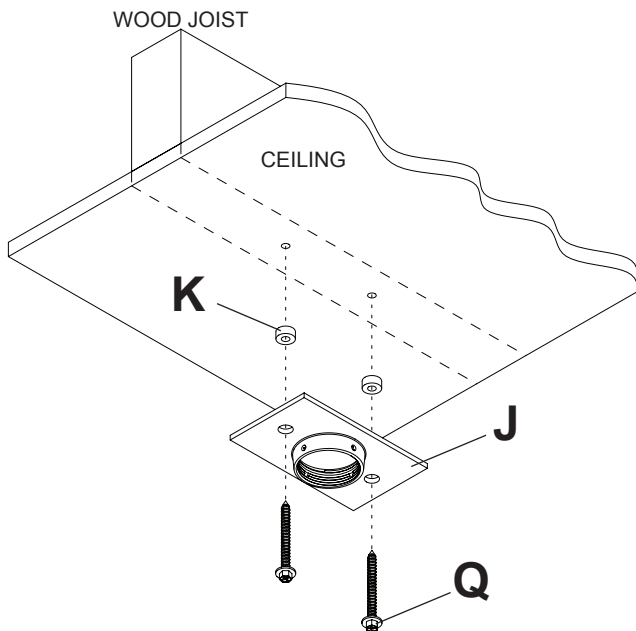

**fig. 1.1**

## **⚠ WARNING**

- Tighten wood screws so that ceiling plate is firmly attached, but do not overtighten. Overtightening can damage the screws, greatly reducing their holding power.
- Never tighten in excess of 80 in • lb (9 N.M.).
- Make sure that mounting screws are anchored into the center of the studs. The use of an "edge to edge" stud finder is highly recommended.
- It is the responsibility of the installer to verify that the supporting surface will safely support the combined load of all attached hardware and components.

**IMPORTANT:** Be sure to drill holes into the joist CENTER!



**fig. 1.2**

# Installation to Concrete Ceilings

## ⚠ WARNING

- Concrete must be 2000 psi density minimum. Lighter density concrete may not hold concrete anchor.
- Installer must verify that the supporting surface will safely support the combined load of the equipment and all attached hardware and components.

**1** Drill two 5/16" (8 mm) dia. holes to a minimum depth of 2.5" (64 mm). Insert anchors (O) in holes flush with wall. Place ceiling plate (J) over anchors and secure using two #14 x 2.5" screws (Q).

**IMPORTANT:** It is the responsibility of the installer to verify that the ceiling will safely support the combined load of all attached hardware and components.

*Skip to step 2 for flush mount installation.*

*Skip to step 3 for extension column installation.*

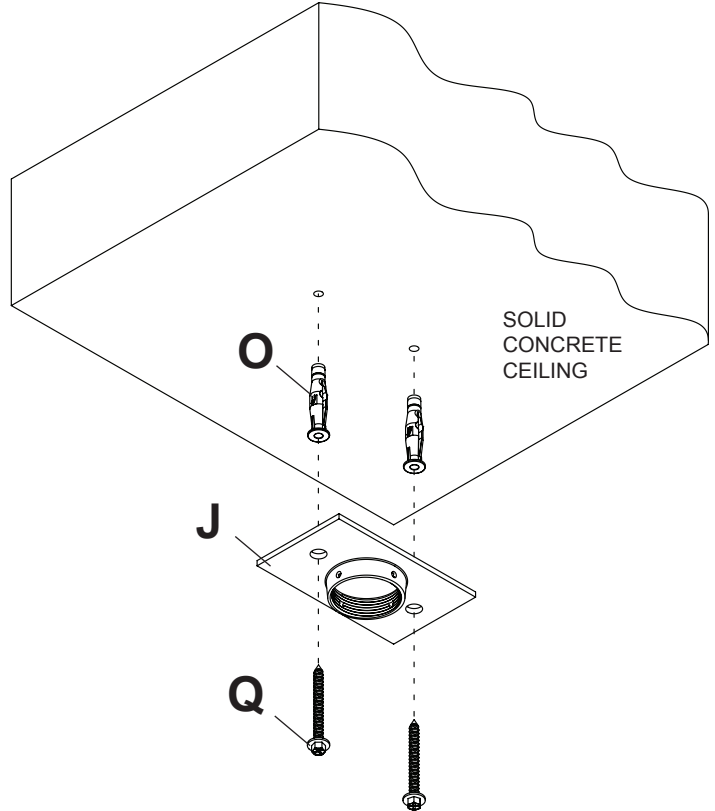

## ⚠ WARNING

- Tighten wood screws firmly, but do not overtighten. Overtightening can damage the screws, greatly reducing their holding power.
- Never tighten in excess of 80 in • lb (9 N.M.).
- Always attach concrete expansion anchors directly to load-bearing concrete.
- Never attach concrete expansion anchors to concrete covered with plaster, drywall, or other finishing material. If mounting to concrete surfaces covered with a finishing surface is unavoidable, the finishing surface must be counterbored as shown below. Be sure concrete anchors do not pull away from concrete when tightening screws. If plaster/drywall is thicker than 5/8" (16 mm), custom fasteners must be supplied by installer.

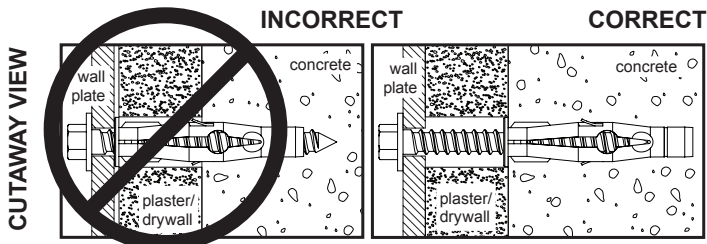

CUTAWAY VIEW

INCORRECT

CORRECT

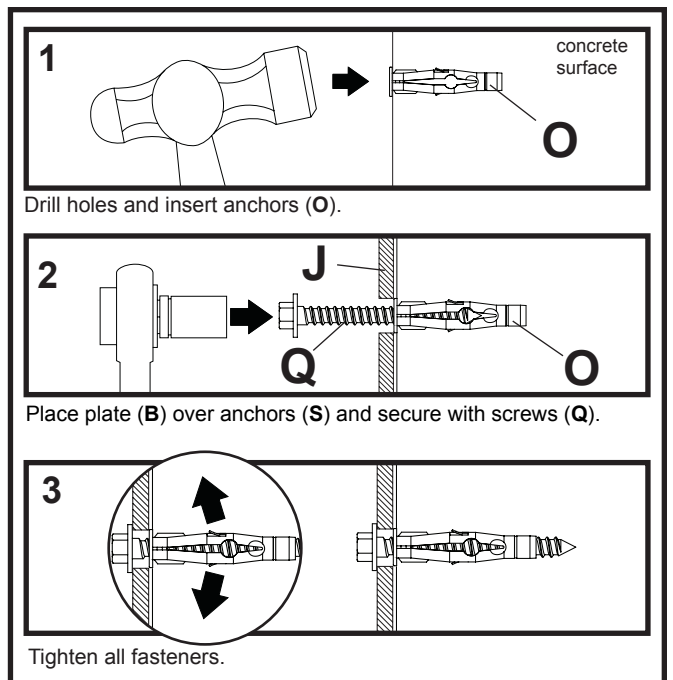

## Flush Mount Installation

- Hand thread projector mount assembly (**H**) into ceiling plate (**J**) as shown in figure 2.1. Align the notch of projector mount assembly with one of the four holes in ceiling plate (**J**) and secure with an M5 x 10 mm socket pin screw (**S**) as shown in detail 1.

**NOTE:** Slotted set screw (**N**) is used to jam against the threads of the projector mount assembly to prevent any excess movement of the projector mount assembly (**H**). Do not overtighten screw; overtightening screw will damage threads making it difficult to separate projector mount assembly from ceiling plate.

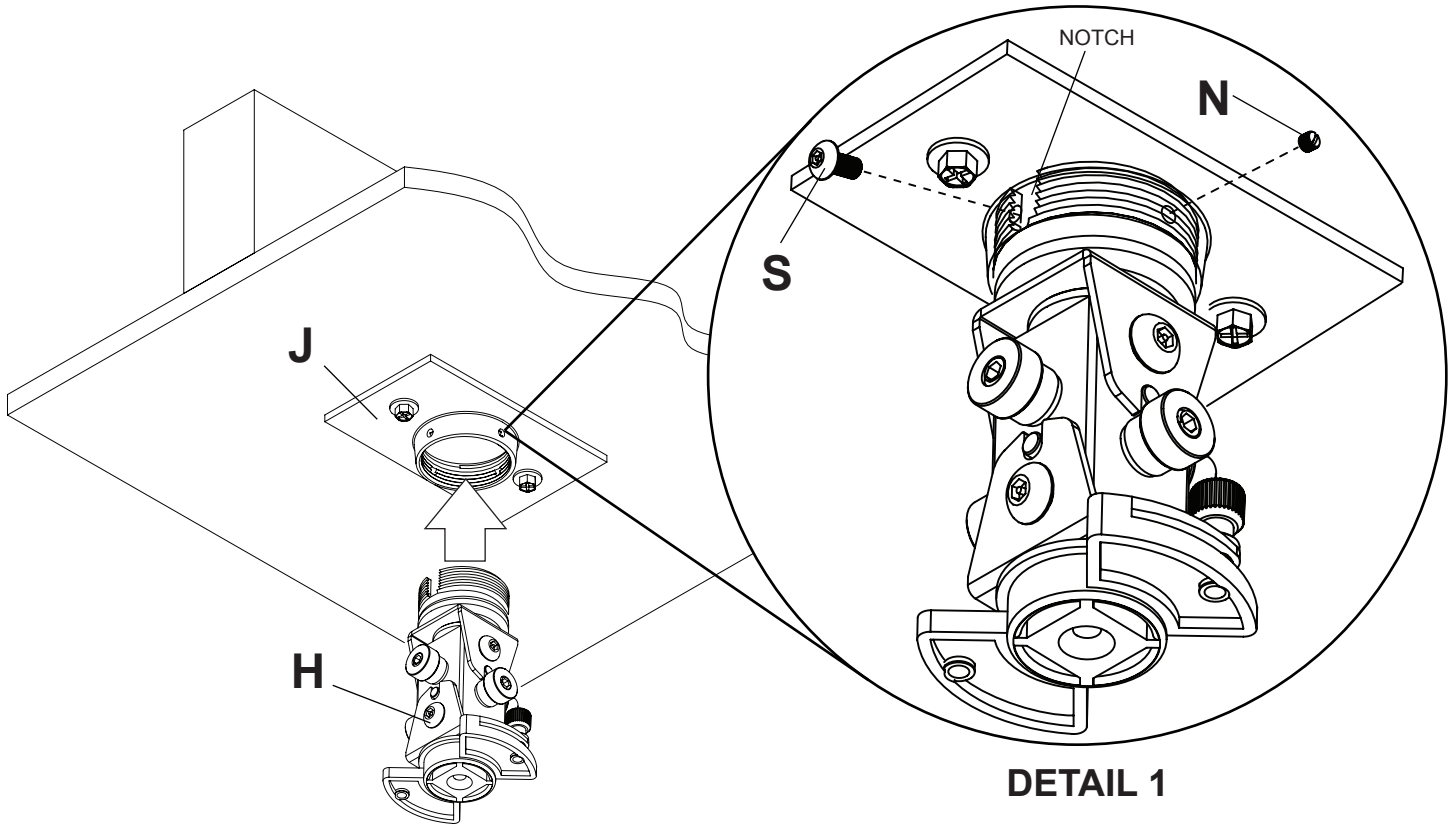

fig. 2.1

## Extension Column Installation

**3** Hand thread extension column into ceiling place (**J**). Align notch of extension column with one of the four holes in ceiling plate (**J**) and secure with an M5 x 10 mm socket pin screw (**S**) using allen wrench (**E**) as shown in detail 2.

Hand thread column connector (**I**) onto extension column. Align slot in extension column with one of the top holes of the column connector (**I**). Insert and tighten one #10-32 x 3/8" socket pin screw (**P**) through column connector (**I**) into slot of extension column using 4 mm security allen wrench (**O**) as shown in detail 3.

Hand thread projector mount assembly (**H**) into column connector (**I**). Align slot of projector mount assembly (**H**) with one of the bottom holes in column connector (**I**). Insert and tighten one #10-32 x 3/8" socket pin screw (**P**) through column connector into projector mount assembly using 4 mm security allen wrench (**E**) as shown in detail 4.

**NOTE:** Slotted set screws (**N**) are used to jam against the threads of each connecting joint to prevent any excess movement. Do not overtighten screw. Overtightening screw will damage threads making it difficult to separate components.

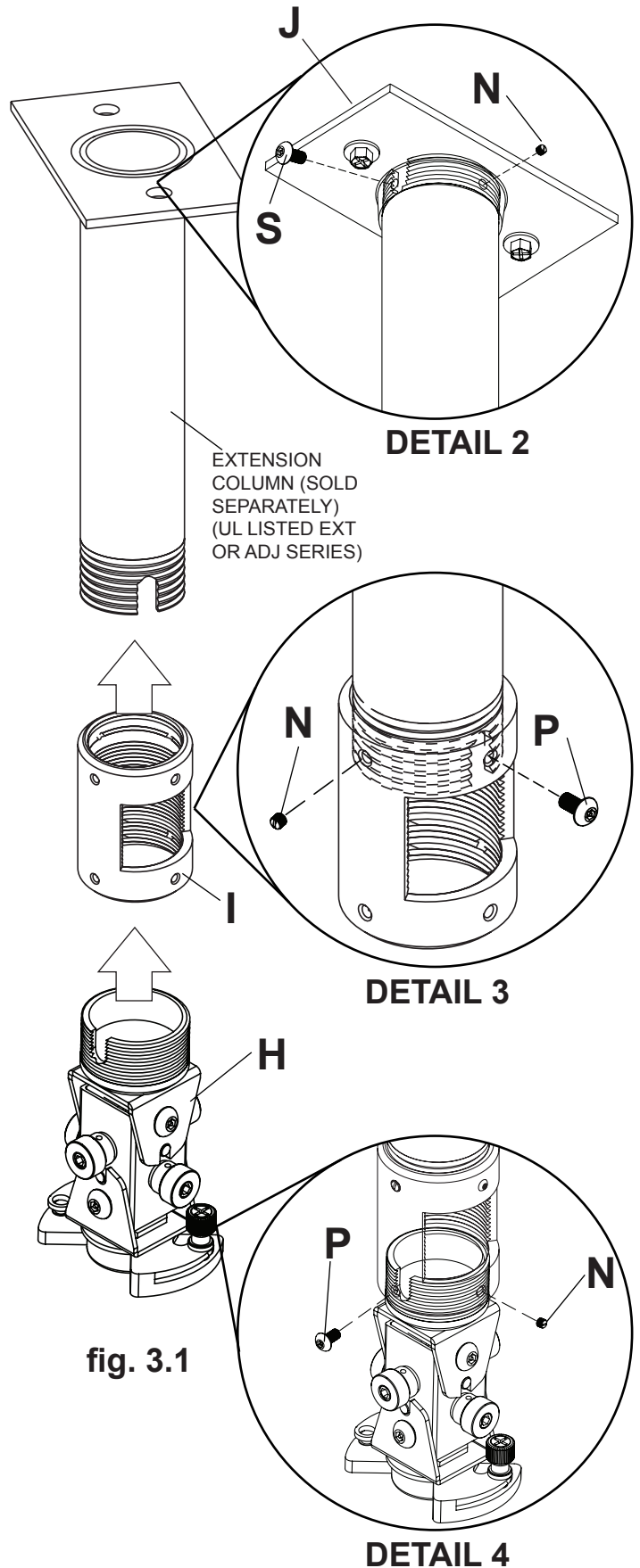

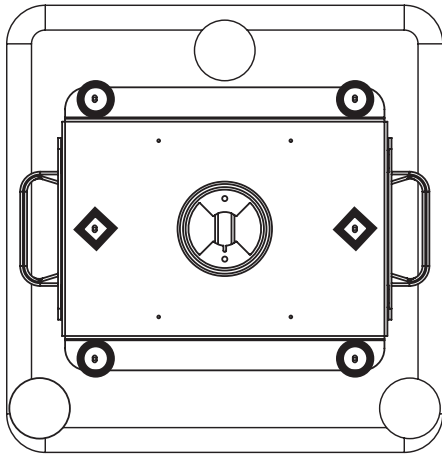

- 4** Fasten adapter assembly (A) to bottom of projector using two M4 x 40 mm socket pin serrated washer head screws (D) with spacers (F and G), and four M4 x 12 mm socket pin serrated washer head screws (B) in orientation as shown below.

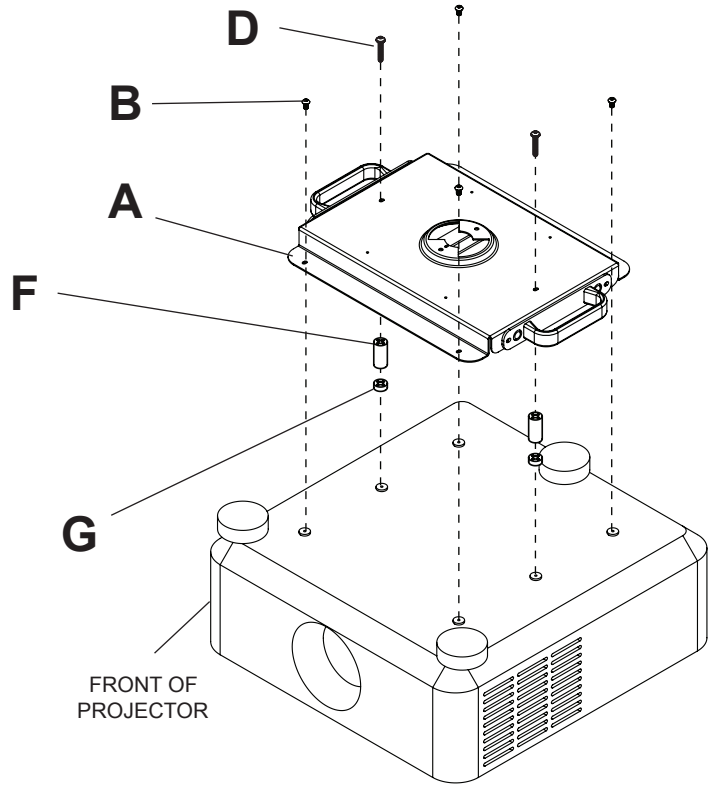

FRONT OF PROJECTOR



-  M4 X 40 MM SOCKET PIN SERRATED WASHER HEAD SCREW (D), WITH SPACERS (F AND G)
-  M4 X 12 MM SOCKET PIN SERRATED WASHER HEAD SCREW (B)

- 5** Handles can be pulled out for additional leverage as shown below.

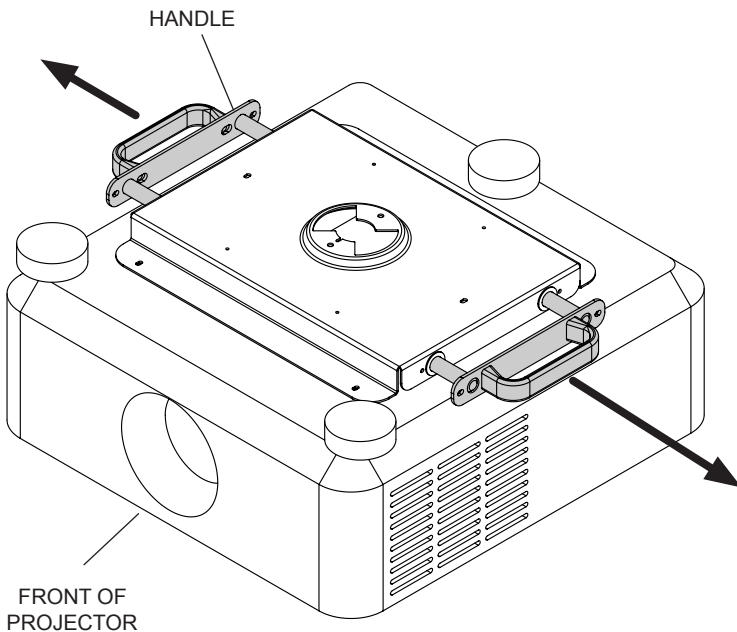

- 6** Handles can be secured to adapter assembly (A) using four M5 x 10 mm socket pin serrated washer head screws (C) as shown below.

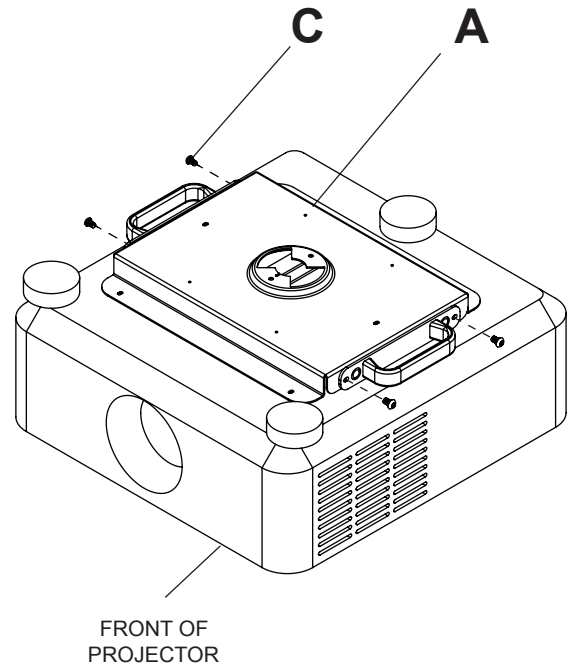

## Attaching Adapter Plate to Projector Mount

**7** Attach projector to projector mount assembly (**H**) by inserting the mount into the adapter plate and twisting until the adapter plate will no longer turn. The spring loaded captive screw should line up with a corresponding hole on the adapter plate. Push down and tighten the spring loaded captive screw to secure the adapter plate to the mount. If not using the optional security feature, fasten thumb screw (**L**) in the hole opposite the spring loaded captive screw.

**OPTIONAL:** For Armor Lock™ security, insert #10-32 x 3/8" serrated washer head screw (**M**) in the hole opposite the spring loaded captive screw. Tighten with 4 mm security allen wrench (**E**). This will prevent the projector from being removed.

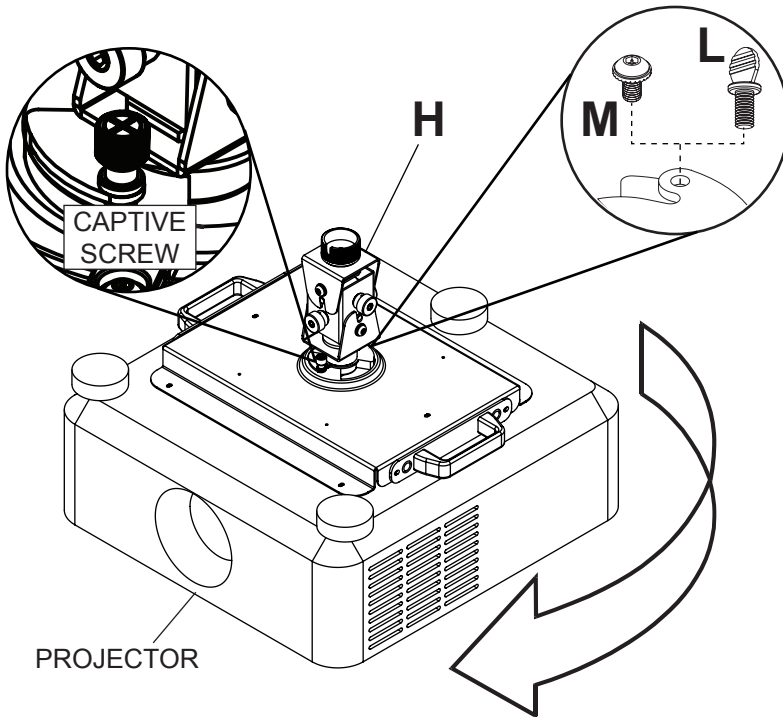

**8** Use knobs to adjust projector mount roll and pitch. Knobs also may be adjusted using allen wrenches (**E,R**).

Tighten socket pin screw using allen wrench (**E**) to lock roll and pitch position.

