



NEC Display Solutions of America, Inc.

Installation and Assembly - Ceiling Mount for NEC NP4000, NP4001 and NP4100 Projector

Model: NP4000CM

Ceiling Mount

1. Remove 1/4"-20 button head bolt on ceiling plate to remove lower portion of mount.
2. Install the ceiling plate with (4) 5/16" bolts to structural attachment points. Lag screws may be used when attaching to wood joists.
3. Reattach the lower portion of the mount.
4. Attach interface plate (pn 72-1073) to projector with (5) M4 x 10 pan head Phillips screws.
5. Align interface plate into holes on mount, slide stand off bolts into slots and tighten. Add center locking Torx cap screw which attach secures the interface plate to the mount.
6. Attach the wire safety rope to the interface plate with the enclosed coupler.
7. Attach power and signal cables to projector.
8. Adjust left-to-right yaw. When desired position is attained, tighten 1/4"-20 ring on coupler to mount.
9. Loosen tilt adjustment cap screw with enclosed tool and level the projected image to the screen. Tighten cap screw when a level image is achieved.
10. Loosen up-down pitch adjustment cap screw with enclosed tool and adjust the pitch angle of the projector. Tighten cap screw when at desired projection position.
11. If desired, add Kensington lock through the opening of the mount head, loop through cable end and attach to projector.

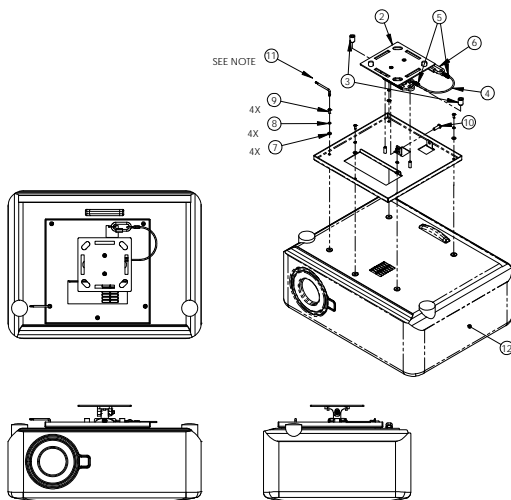

ITEM NO	QTY	PART NO	DESCRIPTION
1	1	72-1072	MOUNT ADAPTER
2	1	72-604	KNUCKLE MOUNT ASM, 1 1/2" SILVER
3	2	72-255SD	THUMB NUT FOR STAT MNTS
4	1	72-054	SAFETY WIRE, 1/8 DIA X 12"
5	2	4600-12800	SLEEVE, ZINC COPPER, 1/8"
6	1	4600-11100	QUICKLINK - 3/16"
7	5	5950-10500	M4, FL WASHER, STL, ZI
8	5	5950-10950	M4, LK WASHER, STL, ZI
9	5	5900-41820	M4X0.7X10, BHCS, PTX, SS
10	1	5900-41910	1/4-20X3/4, BHCS, PTX, SS
11	1	2600-16400	TORX T15 TAMPERPROOF L-KEY
12	1	-	NEC NP4000

ITEM 11 INCLUDED IN KIT WITH CEILING MOUNT PARTS.

5880 Sheridan Boulevard, Arvada, Colorado 80003

Ph: 303-412-0399 ▪ Fax: 303-412-9346

www.displaydevices.com

Pole Mount

1. Install a 1 1/2" NPT pipe with male threads on lower end from the ceiling. Aftermarket mounting pans and accessories are available.
2. Thread locking ring onto pipe. Thread mount (pn 72-046) onto pipe and leave locking ring loose.
3. Attach interface plate (pn 72-1073) to projector with (5) M4 x 10 pan head Phillips screws, lock and flat washers.
4. Align interface plate into holes on mount, slide stand off bolts into slot and tighten. Add center locking Torx cap screw which attach secures the interface plate to the mount.
5. Attach the wire safety rope to the interface plate with the enclosed coupler.
6. Insert power and signal cables through pipe and out the top of the mount head to the projector and attach to projector.
7. Adjust left-to-right yaw. When desired position is attained, tighten locking ring on pipe to mount.
8. Loosen tilt adjustment cap screw with enclosed tool and level the projected image to the screen. Tighten cap screw when a level image is achieved.
9. Loosen up-down pitch adjustment cap screw with enclosed tool and adjust the pitch angle of the projector. Tighten cap screw when at desired projection position.
10. If desired, add Kensington lock through the opening of the mount head, loop through cable end and attach to projector.

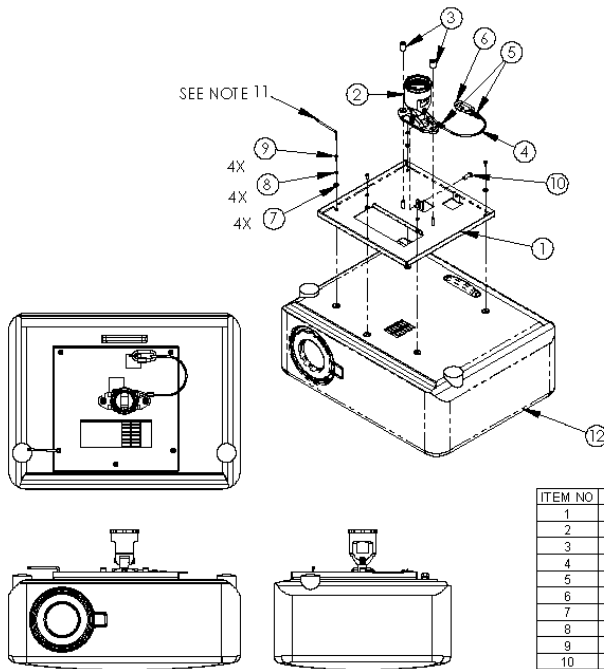

ITEM NO	QTY	PART NO	DESCRIPTION
1	1	72-1072	MOUNT ADAPTER
2	1	72-604	KNUCKLE MOUNT ASM, 1 1/2" SILVER
3	2	72-255SD	THUMB NUT FOR STAT MNTS
4	1	72-054	SAFETY WIRE, 1/8 DIA X 12"
5	2	4600-12800	SLEEVE, ZINC COPPER, 1/8"
6	1	4600-11100	QUICKLINK - 3/16"
7	5	5950-10500	M4, FL WASHER, STL, ZI
8	5	5950-10950	M4, LK WASHER, STL, ZI
9	5	5900-41820	M4X0.7X10,BHCS,PTX,SS
10	1	5900-41910	1/4-20X3/4,BHCS,PTX,SS
11	1	2600-16400	TORX T15 TAMPERPROOF L-KEY
12	1	-	NEC NP4000

ITEM 11 INCLUDED IN KIT WITH CEILING MOUNT PARTS.